

KANSAS CORPORATION COMMISSION
OIL & GAS CONSERVATION DIVISION

Form T-1
July 2014

Form must be Typed
Form must be Signed
All blanks must be Filled

**REQUEST FOR CHANGE OF OPERATOR
TRANSFER OF INJECTION OR SURFACE PIT PERMIT**

Form KSONA-1, Certification of Compliance with the Kansas Surface Owner Notification Act,
MUST be submitted with this form.

Check Applicable Boxes:

- Oil Lease: No. of Oil Wells _____ **
- Gas Lease: No. of Gas Wells _____ **
- Gas Gathering System: _____
- Saltwater Disposal Well - Permit No.: _____
Spot Location: _____ feet from N / S Line
_____ feet from E / W Line
- Enhanced Recovery Project Permit No.: _____
Entire Project: Yes No
Number of Injection Wells _____ **

Field Name: _____

**** Side Two Must Be Completed.**

Effective Date of Transfer: _____

KS Dept of Revenue Lease No.: _____

Lease Name: _____

_____ Sec. _____ Twp. _____ R. _____ E W

Legal Description of Lease: _____

County: _____

Production Zone(s): _____

Injection Zone(s): _____

Surface Pit Permit No.: _____
(API No. if Drill Pit, WO or Haul)

_____ feet from N / S Line of Section

_____ feet from E / W Line of Section

Type of Pit: Emergency Burn Settling Haul-Off Workover Drilling

Past Operator's License No. _____

Contact Person: _____

Past Operator's Name & Address: _____

Phone: _____

Title: _____

Signature: _____

New Operator's License No. _____

Contact Person: _____

New Operator's Name & Address: _____

Phone: _____

Title: _____

Signature: _____

Oil / Gas Purchaser: _____

Date: _____

Acknowledgment of Transfer: The above request for transfer of injection authorization, surface pit permit # _____ has been noted, approved and duly recorded in the records of the Kansas Corporation Commission. This acknowledgment of transfer pertains to Kansas Corporation Commission records only and does not convey any ownership interest in the above injection well(s) or pit permit.

_____ is acknowledged as
the new operator and may continue to inject fluids as authorized by
Permit No.: _____ . Recommended action: _____

Date: _____
Authorized Signature

_____ is acknowledged as
the new operator of the above named lease containing the surface pit
permitted by No.: _____ .

Date: _____
Authorized Signature

DISTRICT _____ EPR _____ PRODUCTION _____ UIC _____

KANSAS CORPORATION COMMISSION
OIL & GAS CONSERVATION DIVISION

Form KSONA-1

July 2014

Form Must Be Typed

Form must be Signed

All blanks must be Filled

**CERTIFICATION OF COMPLIANCE WITH THE
KANSAS SURFACE OWNER NOTIFICATION ACT**

This form must be submitted with all Forms C-1 (Notice of Intent to Drill); CB-1 (Cathodic Protection Borehole Intent); T-1 (Request for Change of Operator Transfer of Injection or Surface Pit Permit); and CP-1 (Well Plugging Application). Any such form submitted without an accompanying Form KSONA-1 will be returned.

Select the corresponding form being filed: C-1 (Intent) CB-1 (Cathodic Protection Borehole Intent) T-1 (Transfer) CP-1 (Plugging Application)

OPERATOR: License # _____

Name: _____

Address 1: _____

Address 2: _____

City: _____ State: _____ Zip: _____ + _____

Contact Person: _____

Phone: (_____) _____ Fax: (_____) _____

Email Address: _____

Well Location:

____ - ____ - ____ - ____ Sec. ____ Twp. ____ S. R. ____ East West

County: _____

Lease Name: _____ Well #: _____

If filing a Form T-1 for multiple wells on a lease, enter the legal description of the lease below:

Surface Owner Information:

Name: _____

Address 1: _____

Address 2: _____

City: _____ State: _____ Zip: _____ + _____

When filing a Form T-1 involving multiple surface owners, attach an additional sheet listing all of the information to the left for each surface owner. Surface owner information can be found in the records of the register of deeds for the county, and in the real estate property tax records of the county treasurer.

If this form is being submitted with a Form C-1 (Intent) or CB-1 (Cathodic Protection Borehole Intent), you must supply the surface owners and the KCC with a plat showing the predicted locations of lease roads, tank batteries, pipelines, and electrical lines. The locations shown on the plat are preliminary non-binding estimates. The locations may be entered on the Form C-1 plat, Form CB-1 plat, or a separate plat may be submitted.

Select one of the following:

- I certify that, pursuant to the Kansas Surface Owner Notice Act (House Bill 2032), I have provided the following to the surface owner(s) of the land upon which the subject well is or will be located: 1) a copy of the Form C-1, Form CB-1, Form T-1, or Form CP-1 that I am filing in connection with this form; 2) if the form being filed is a Form C-1 or Form CB-1, the plat(s) required by this form; and 3) my operator name, address, phone number, fax, and email address.
- I have not provided this information to the surface owner(s). I acknowledge that, because I have not provided this information, the KCC will be required to send this information to the surface owner(s). To mitigate the additional cost of the KCC performing this task, I acknowledge that I must provide the name and address of the surface owner by filling out the top section of this form and that I am being charged a \$30.00 handling fee, payable to the KCC, which is enclosed with this form.

If choosing the second option, submit payment of the \$30.00 handling fee with this form. If the fee is not received with this form, the KSONA-1 form and the associated Form C-1, Form CB-1, Form T-1, or Form CP-1 will be returned.

I hereby certify that the statements made herein are true and correct to the best of my knowledge and belief.

Date: _____ Signature of Operator or Agent: _____ Title: _____

State of Kansas, Barber Co., ss
This instrument was filed for record on
the 6 day of May
2019 at 9:30 o'clock A.M., and
duly recorded in book 368 on page 352
Betty S. Subyden
Register of Deeds
Fees \$21.00

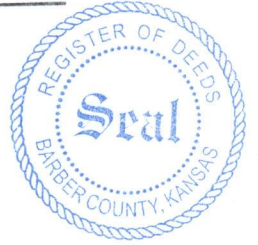

PARTIAL ASSIGNMENT OF OIL AND GAS LEASE

STATE OF KANSAS)
) ss.
COUNTY OF BARBER)

KNOW ALL MEN BY THESE PRESENTS:

THAT **Raymond Oil Company, LP, P.O. Box 48788, Wichita, KS 67201-8788**, hereinafter referred to as Assignor, for and in consideration of Ten Dollars (\$10.00) and other valuable consideration, the receipt whereof is hereby acknowledged, does hereby sell, assign, transfer and set over unto **Drop Tine Exploration, LLC, 7767 NW Elm Mills Road, Sawyer, KS 67134**, hereinafter referred to as Assignee, all right, title and interest in and to the Oil and Gas Lease, **insofar, and only insofar as it only covers the Southeast Quarter (SE/4) of Section 6, Township 32 South, Range 13W, Barton County, Kansas**, described as follows:

Lessor: Mark J. Dugan and Shirley A. Dugan, Trustees of the
 Mark J. Dugan Revocable Trust dated June 13, 2001
Lessee: Raymond Oil Company, Inc.
Lease Date: November 20, 2003
Recorded: Book 297, Page 152
Description: The Northeast Quarter (NE/4), the Southeast Quarter (SE/4), the Southwest Quarter (SW/4), and the South Half of the South Half of the Northwest Quarter (S/2 S/2 NW/4), except for a forty (40) acre tract, described as the Southeast Quarter of the Northeast Quarter (SE/4 NE/4) of Section 6, Township 32 South, Range 13 West, Barton County, Kansas,

together with the rights incident thereto and the personal property thereon, appurtenant thereto, or used or obtained in connection therewith.

This assignment is made subject to all of the express and implied covenants and conditions of the herein described lease, which terms, covenants and conditions Assignee hereby assumes and agrees to perform with respect to the interest hereby assigned in said lease. This assignment is made without warranty of title either express or implied.

EXECUTED this 18th day of April, 2019, but to be effective the 1st day of May, 2019.

RAYMOND OIL COMPANY, LP

By: W.S. Raymond
William S. Raymond, President of
Raymond Oil Company, Inc., the General
Partner of Raymond Oil Company, LP

STATE OF KANSAS)
) ss.
COUNTY OF SEDGWICK)

BE IT REMEMBERED that on this 18th day of April, 2019, before me, the undersigned, a Notary Public, in and for the County and State aforesaid, came **William S. Raymond, President of Raymond Oil Company, Inc., the General Partner of Raymond Oil Company, LP**, and in that capacity, being authorized to do so, executed the foregoing instrument for the purposes therein stated.

IN WITNESS WHEREOF, I have hereunto set my hand and affixed my official seal the day and year last above written.

Karen Cunningham
Notary Public

My Appointment Expires:
8-26-2021

