

SHOWING WATER-LEVEL CONTOURS, OCTOBER 1959, ACREAGE FOR WHICH APPLICATIONS FOR WATER RIGHTS HAVE BEEN RECEIVED, AND LOCATION OF WELLS AND TEST HOLES.

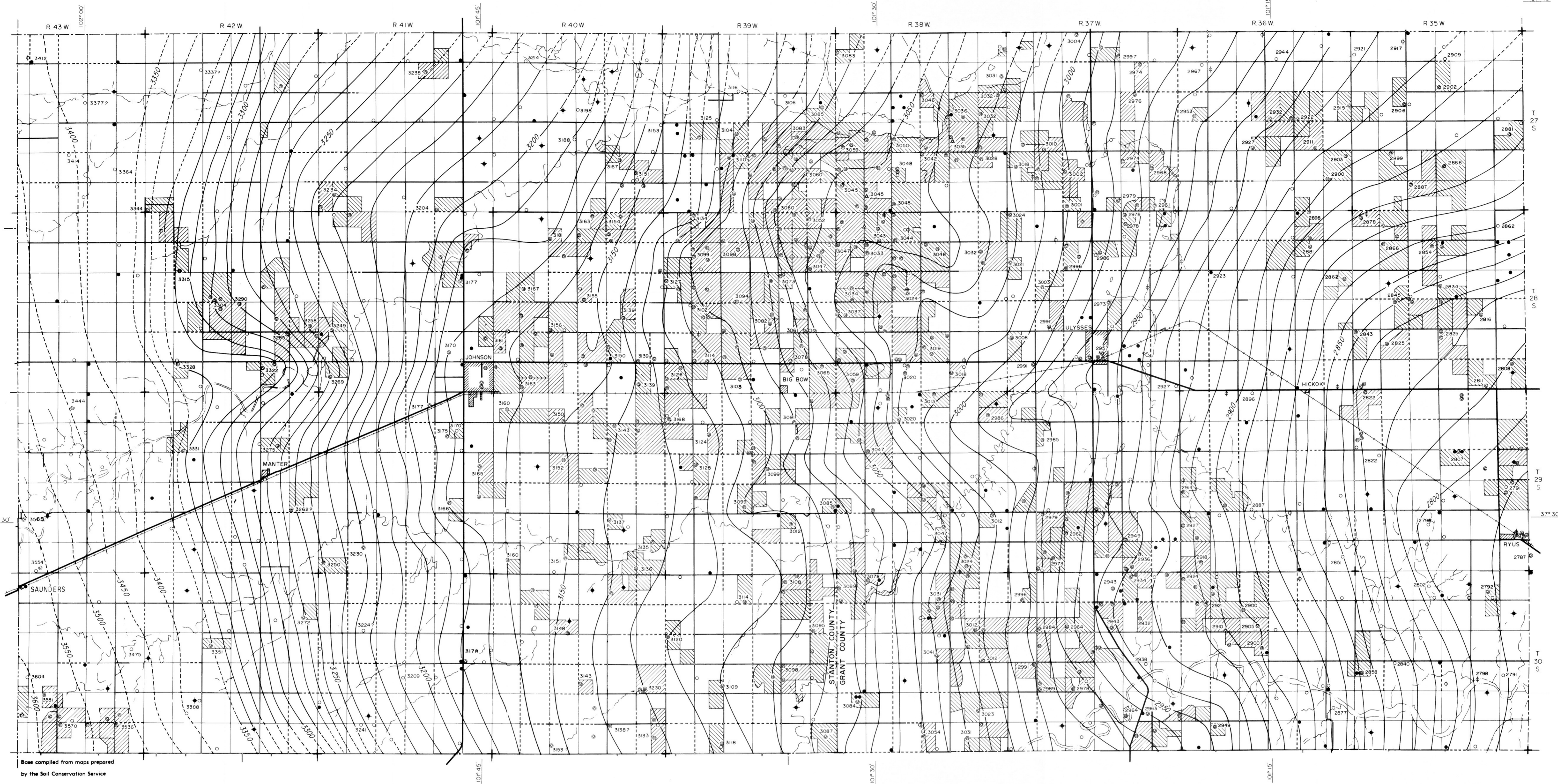

EXPLANATION

- | | | | |
|--------|--|----------|--|
| ○ 2917 | Altitude of water level in feet above mean sea level, October 1959 (queried where doubtful). | ● | Oil or gas test hole. |
| ○ | Domestic well. | △ | Well equipped with recording gage. |
| ● | Test hole. | ▨ ▨ | Acreage for which applications for water rights have been received. |
| ⊙ | Irrigation, public supply, or industrial well. | — 3150 — | Contour on the water table (dashed where approximate). Interval 10 feet and 50 feet. |
| ⊕ ⊕ | Abandoned or destroyed well. | | |

